



 2

 2

 1

 C

DavidJames
the estate agent

Nightingale House, Ockbrook Drive, Nottingham, NG3 6AT

Guide Price £160,000

About This Property

GUIDE PRICE £160,000 - £170,000 We are delighted to present this top-floor penthouse apartment in the stunning Nightingale House which is offered to the market with no upward chain!

Having undergone a recent redecoration throughout, the interior welcomes with a fresh, neutral palette and is ready to accommodate the new owner's personal touch. Full of character and with high-ceilings throughout, this apartment would be perfect for a first-time buyer looking for a move-in-ready home or for investors seeking a turn-key opportunity. Its location is notably convenient, positioned within arm's reach of Mapperley's superb amenities and not far from Nottingham City Centre. The addition of frequent bus services nearby ensures commuting is effortless and straightforward.

Located on the top floor, the property enjoys a private landing which leads to an entrance hall, complete with an intercom system for secure access. The heart of the home is a generous open-plan living area, seamlessly blending a lounge, dining space and a well-appointed kitchen. The kitchen comes equipped with an integrated oven, hob with extractor fan, dishwasher and washing machine alongside space for an integrated fridge.

The two double bedrooms, with the main bedroom benefiting from fitted wardrobes, are complemented by a shower room with a three-piece white suite.

Management by the respected MPM ensures the communal grounds are well-maintained under the service agreement whilst security is prioritized, with cameras and external lighting in place for residents' peace of mind.

Additionally, a parking space at the front of the property adds to the convenience offered by this exceptional apartment.



- Top floor apartment in the stunning Nightingale House
- Recently redecorated and move-in ready
- A perfect first-time buy or investment purchase
- Offered to the market with no upward chain
- Within easy reach of Mapperley's amenities and Nottingham City Centre
- Bright and spacious open plan living space
- Fitted kitchen with a range of integrated appliances
- Two double bedrooms (main bedroom with fitted wardrobes)
- Shower room with three-piece white suite
- Parking space set within well-maintained communal grounds

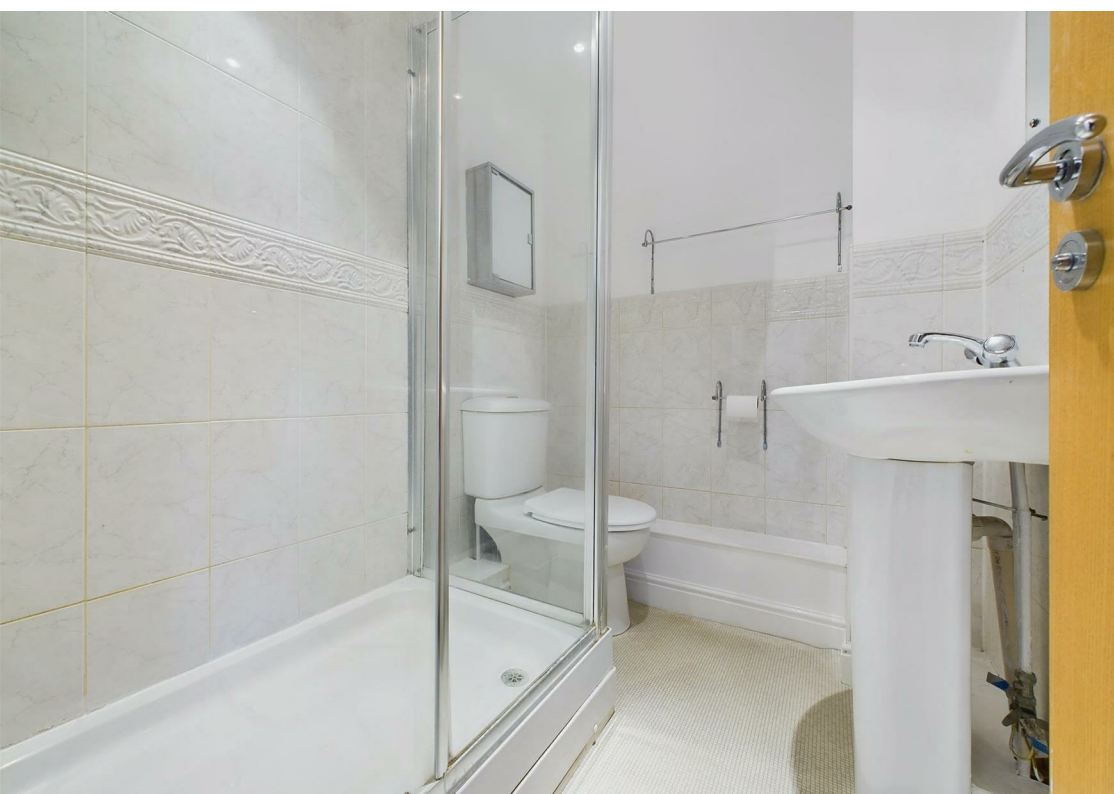

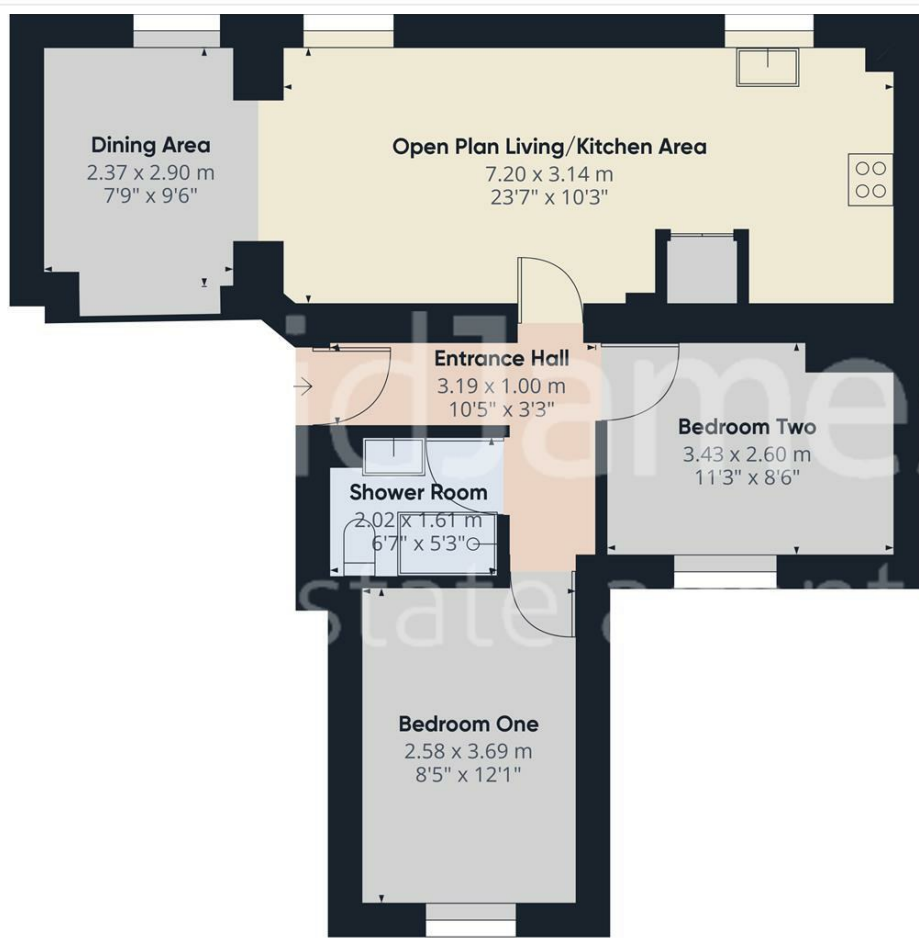

Approximate total area**
58.35 m²
628.03 ft²

(*) Excluding balconies and terraces

While every attempt has been made to ensure accuracy, all measurements are approximate, not to scale. This floor plan is for illustrative purposes only.

GIRAFFE360



These particulars are produced in good faith, are set out as a general guide only and do not constitute any part of a contract. No person in the employment of David James Estate Agents Ltd has any authority to make any representation whatsoever in relation to the property. All services, together with electrical fittings or fitted appliances have NOT been tested. All the measurements given in the details are approximate. Floor plans are for illustrative purposes only and are not drawn to scale. The position and size of doors, windows, appliances and other features are approximate only. The photographs of this property have been taken with a 10mm wide-angle lens. No responsibility can be accepted for any loss or expense incurred in viewing. If you have a property to sell you may wish to take advantage of our free valuation service. David James Estate Agents have established professional relationships with third-party suppliers for the provision of services to Clients. As remuneration for this professional relationship, the agent receives referral commission from the third-party company. David James Estate Agents receives the following commission from each third party supplier on a per referral basis: W A Barnes Ltd: £60 including VAT. All Moves UK Ltd: 18% including VAT of the invoice total (£107 including VAT average). MoveWithUs Limited: £188 including VAT (average).

Council Tax Band: C
Nottingham City Council
Leasehold

DavidJames
the estate agent

David James Estate Agents
45b Plains Road, Nottingham, NG3 5JU
t: 0115 962 4213 e: mapperley@david-james.com

